



# 3/4" BORE STAINLESS STEEL CYLINDER

## USN-12-□-□

Single Acting

**Mount:** Universal    **Standard Stroke Lengths:** 1/2", 1", 1-1/2", 2", 3", 4"  
**Type:** Non-Rotating Rod    **Spring Compressed:** 6 lbs.    **Spring At Rest:** 3 lbs.  
**Options:** M, B, H, V, P6, N    **Maximum Stroke:** 25"    For B option add 0.500  
For M option add 0.125

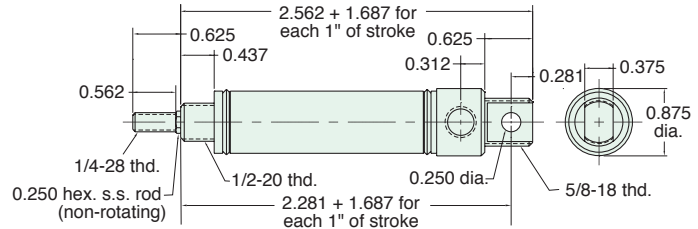

Furnished without nut(s). See Chart on Page 24.

## USR-12-□-□

Single Acting

**Mount:** Universal    **Standard Stroke Lengths:** 1/2", 1", 1-1/2", 2", 3", 4"  
**Type:** Rotating Rod    **Spring Compressed:** 6 lbs.    **Spring At Rest:** 3 lbs.  
**Options:** M, B, H, V, P6, N, W    **Maximum Stroke:** 25"    For B option add 0.500  
For M option add 0.125

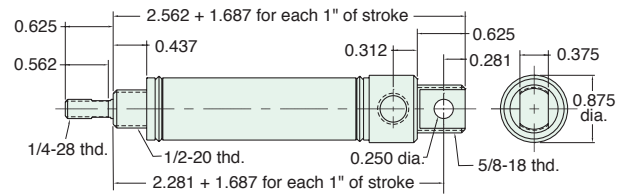

Furnished without nut(s). See Chart on Page 24.

## FDR-12-□-□

Double Acting

**Mount:** Front    **Standard Stroke Lengths:** 1/2", 1", 1-1/2", 2", 3", 4", 5", 6"  
**Type:** Rotating Rod    **Maximum Stroke:** 42"  
**Options:** M, B, W, V, P6, P7, P8, S, N    For B option add 0.500  
For S option add 0.437

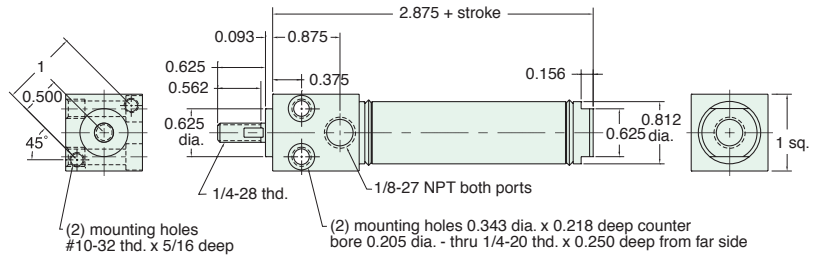

Furnished without nut(s). See Chart on Page 24.

## TDR-12-□-□

Double Acting

**Mount:** Trunnion    **Standard Stroke Lengths:** 1/2", 1", 1-1/2", 2", 3", 4", 5", 6"  
**Type:** Rotating Rod    **Maximum Stroke:** 42"  
**Options:** M, B, W, V, S, N, P6, P7, P8    For B option add 0.500  
For S option add 0.437

